



Sound Bomb Split Horn Mount

BMW R1300GS
HMT.07.11200

Thank you for choosing DENALI

We know you would rather be riding your bike than wrenching on it, so we go the extra mile to make sure our instructions are clear and as easy to understand as possible. If you have any questions, comments, or suggestions don't hesitate to give our gear experts a call at 401.360.2550 or visit WWW.DENALIELECTRONICS.COM

Please Read Before Installing

DENALI products should always be installed by a qualified motorcycle technician. If you are unsure of your ability to properly install a product, please have the product installed by your local motorcycle dealer. DENALI takes no responsibility for damages caused by improper installation. **Caution:** When installing electronics it is extremely important to pay close attention to how wires are routed, especially when mounting products to the front fender, front forks, or fairing of your motorcycle. Always be sure to turn the handlebars fully left, fully right, and fully compress the suspension to ensure the wires will not bind and have enough slack for your motorcycle to operate properly.

Installation Tips

We strongly recommend using medium strength liquid thread locker on all screws, nuts, and bolts. It is also important to ensure that all hardware is tightened to the proper torque specifications as listed in your owner's manual. For included accessory hardware please refer to the default torque specifications provided below. Inspect all hardware after the first 30 miles to ensure proper torque specifications are maintained.

Bolt Size	in-lbs	ft-lbs	Nm
M3	10.0 in-lbs	-	1.0 Nm
M4	23.0 in-lbs	-	2.5 Nm
M5	44.5 in-lbs	3.5 ft-lbs	5.0 Nm
M6	78.0 in-lbs	6.5 ft-lbs	9.0 Nm
M8	-	13.5 ft-lbs	18.0 Nm
M10	-	30.0 ft-lbs	41.0 Nm
M12	-	52.0 ft-lbs	71.0 Nm

Hardware Sizing Guide

Not sure what size bolt you have? Use this ruler to measure screws, bolts, spacers, etc. Remember, the length of a screw or bolt is measured from the start of the "mounting surface" to the end of the screw, so only include the screw head when measuring countersunk screws.

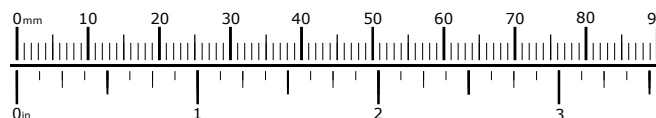

What's In The Box?

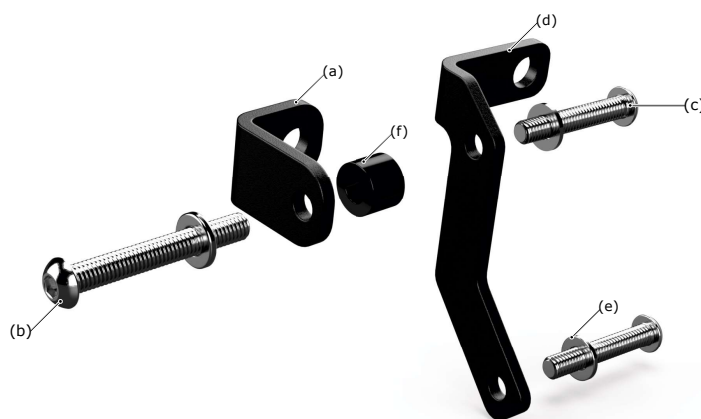

Kit Contents

- (a) Horn Compressor bracket (HMT.07007-01).....Qty 1
- (b) M6x45mm Mounting Bolt.....Qty 1
- (c) M6x35mm Mounting Bolt.....Qty 2
- (d) Acoustic Unit Mounting Bracket (HMT.07.11200-02).....Qty 1
- (e) M6 Washer.....Qty 3
- (f) M6 x 9.5mm spacer.....Qty 1

Tools Required:

- (a) Allen Key Set
- (b) Torx Bit set
- (c) 13mm Wrench
- (d) Torque Wrench

1. Installing The Acoustic Housing

DENALIELECTRONICS.COM

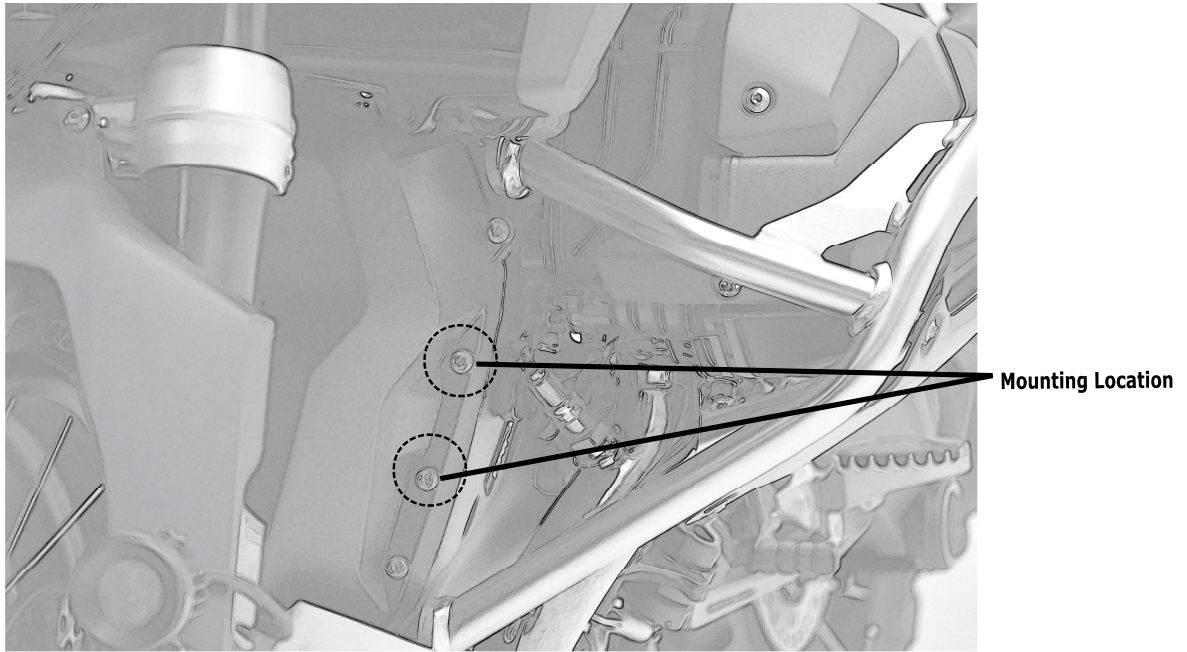

1.1 - Mounting Location - Acoustic Unit

Step One: On the clutch side of the bike, 2nd and 3rd fastener from the bottom. Remove the two T30 torx screws from the engine case.

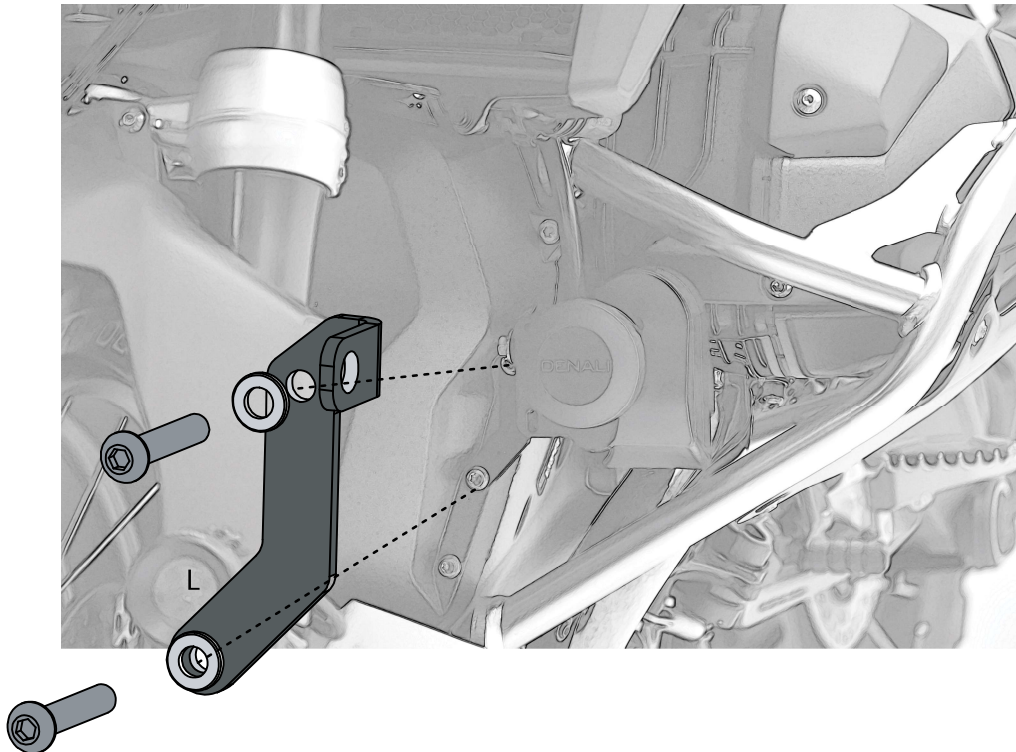

1.2 - Assembling the Bracket

Step One: Using the supplied M6 x 35mm screws, mount the acoustic unit bracket to the engine case. Torque these screws to 36in-lbs or 4NM.

1.3 - Mounting the Bracket and Horn

Step One: Mount the SoundBomb acoustic housing to the bracket using the hardware supplied with the SoundBomb Horn Kit.

2. Installing The Compressor

DENALIELECTRONICS.COM

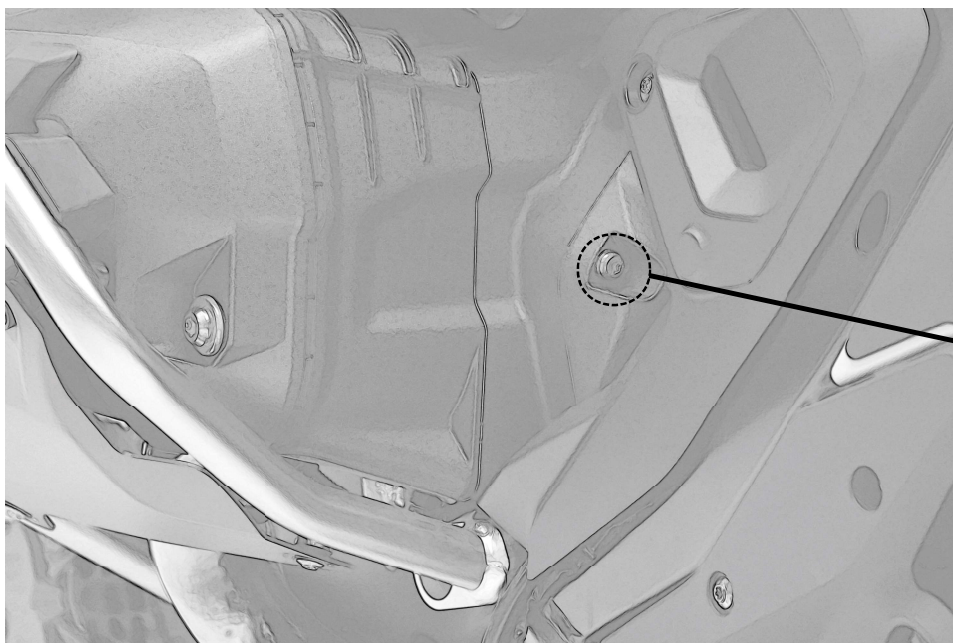

Mounting Location

2.1 - Mounting Location

Step One: On the clutch side of the bike on the rear of the clutch side cylinder head. Remove the T30 torx screw from the engine case shown above.

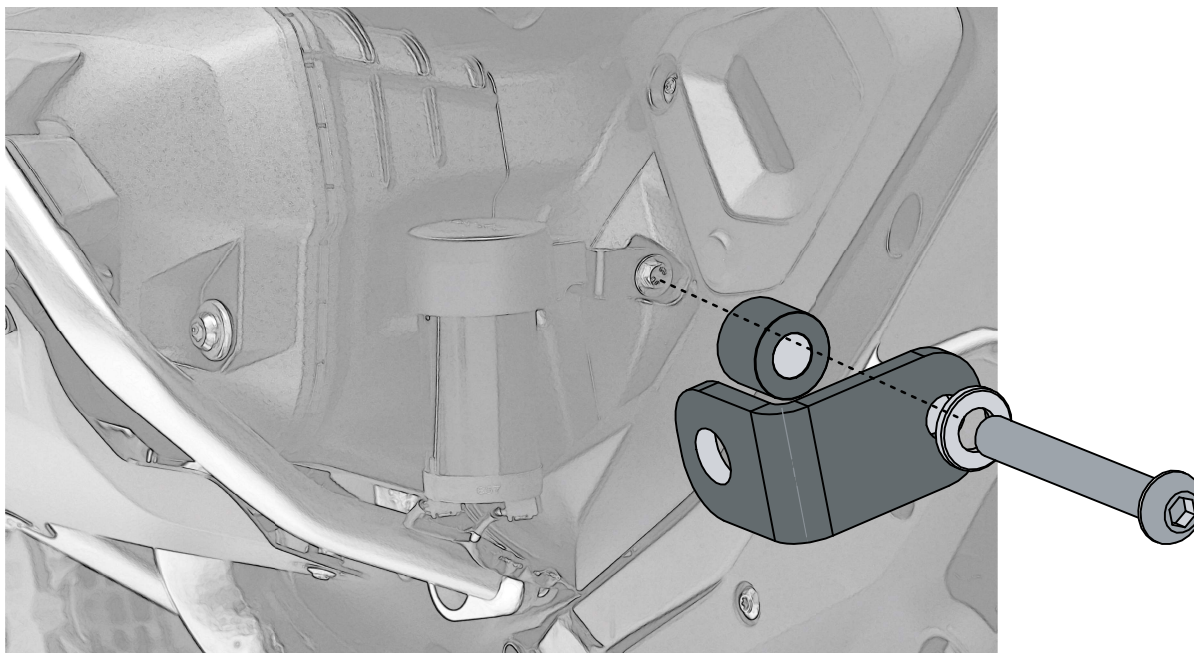

2.2 - Assembling the Bracket

Step One: Mount the Compressor Unit to the bracket using the hardware supplied in the Sound Bomb Kit.

2.3 - Mounting the Bracket and Horn

Step One: Using the supplied M6 x 45mm screw, mount the Compressor Unit bracket to the engine case. Torque these screws to 36in-lbs or 4NM.